

15" ASPHALTIC CONCRETE, TYPE PER SPECIFICATIONS. COMPACT TO 95% MIX DESIGN DENSITY.

6" LIMEROCK BASE COURSE MIN LBR 100, COMPACT TO 95% MAX DENSITY AASHTO T-180

12" STABILIZED SUBGRADE MIN LBR 40, COMPACT TO 95% MAX DENSITY

SAWCUT AND REMOVE EXISTING PAVEMENT & REPLACE WITH 1.5" ASPHALTIC CONCRETE, TYPE PER SPECIFICATIONS, COMPACT TO 95% MIX DESIGN DENSITY.

RESTORE DETERIORATED LIMEROCK TO WITHIN 1.5" OF FINAL GRADE, MIN LBR 100, COMPACT TO 95% MAX DENSITY AASHTO T-180

EXISTING VARIABLE DEPTH LIMEROCK BASE

1 TYPICAL NEW PARKING LOT PAVEMENT SECTION

2 TYPICAL PARKING LOT PAVEMENT REPAIR SECTION

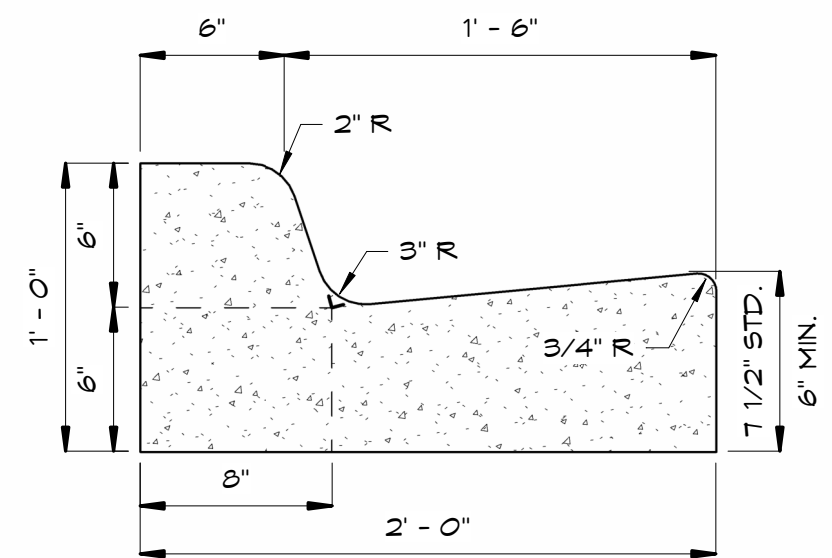
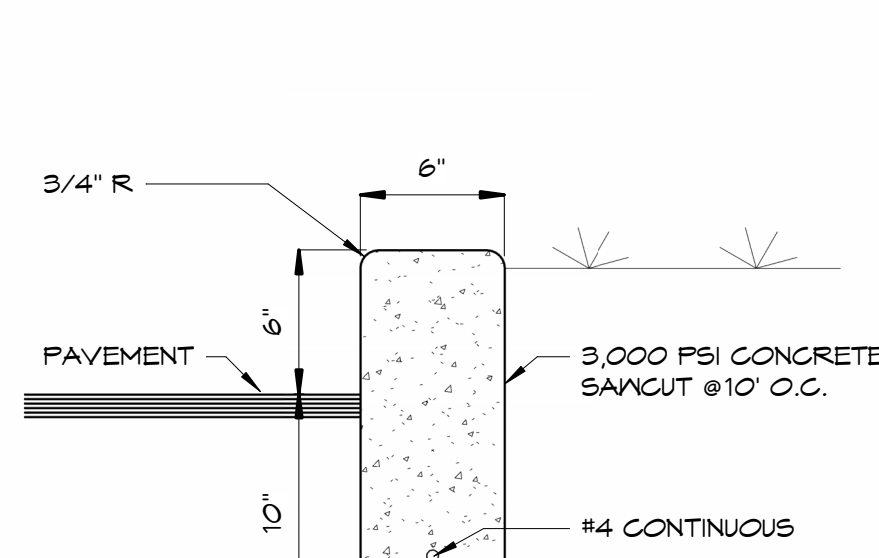

SURFACE ON LOW SIDE OF PAVEMENT TO BE 1/4" ABOVE LIP OF GUTTER EXCEPT FC-2 TO BE 5/8" AND FC-3 TO BE 3/4" ABOVE LIP. SURFACE ON HIGH SIDE TO BE FLUSH WITH GUTTER.

2' - 0"

1' - 0"

1' - 0"

R=1/2"

6"

1/2"

TOP OF PAVEMENT

6"

3 TYPICAL 6" CURB

4 CURB & GUTTER TYPE "F"
1 1/2" = 1'-0"

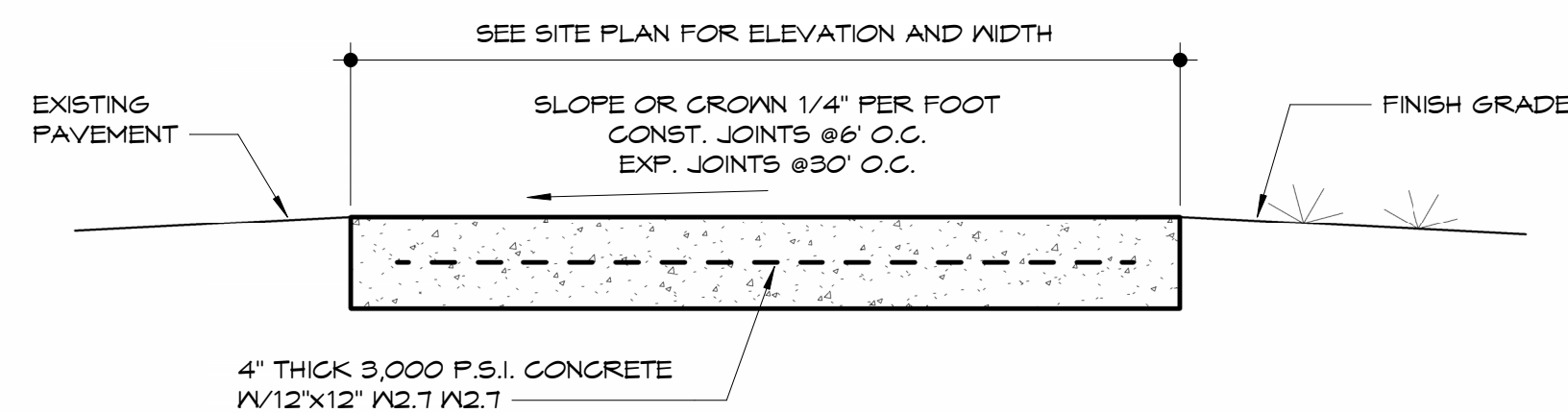

Diagram illustrating the cross-section of a concrete slab on grade. The slab is 8" wide and 12" thick. The top 4" layer is 3,000 PSI concrete with W1/2 x 12 #2.7 bars. The bottom 4" layer is #5 rebar continuous. A 45° angle is indicated at the bottom right corner.

6 TYPICAL SIDEWALK DETAIL

7 RAISED SIDEWALK DETAIL (ADJACENT TO PAVEMENT)
1 1/2" = 1'-0"

Diagram illustrating a vertical wall and two inclined beams. The top beam is 6' long and perpendicular to the wall. The bottom beam is 6' long and perpendicular to the wall. The angle between the two beams is 3'-0".

8 TYPICAL STRIPING DETAIL

NOT TO SCALE

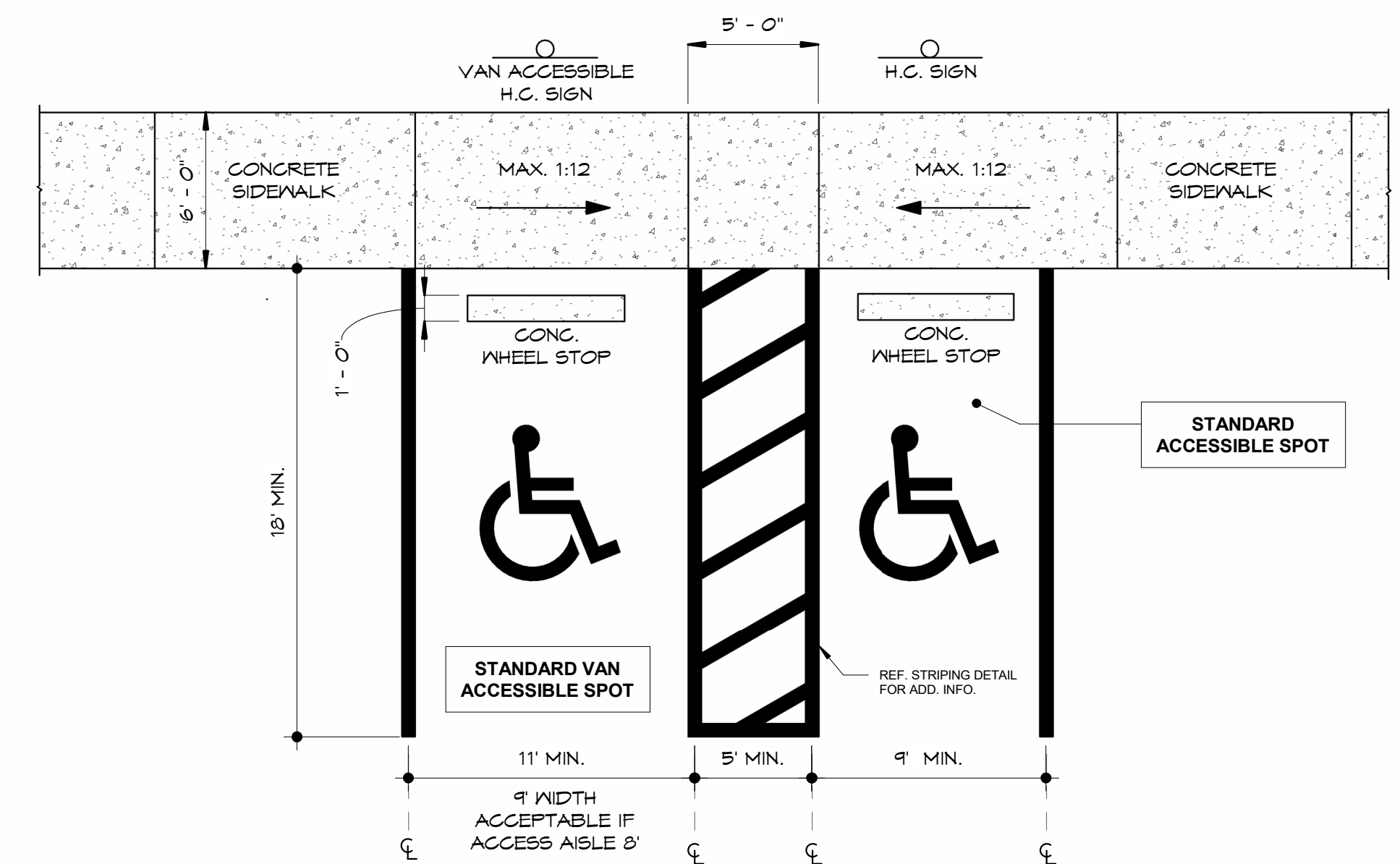

9 HANDICAP PARKING LAYOUT AND STRIPING DETAIL

NOT TO SCALE

8

Q

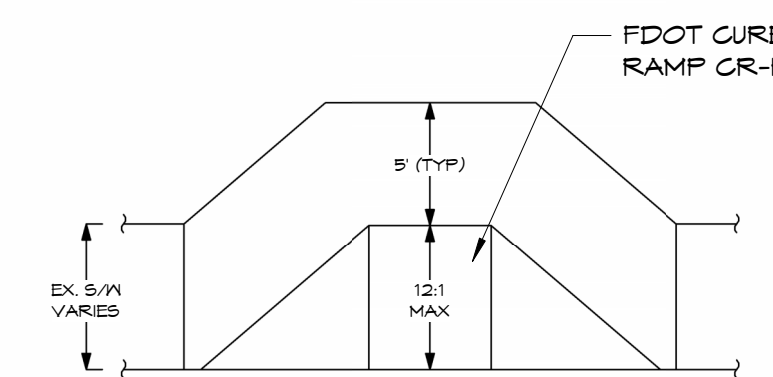

10 TAPERED RAMP WITH WALK-AROUND SIDEWALK DETAIL
1/8" = 1'-0"

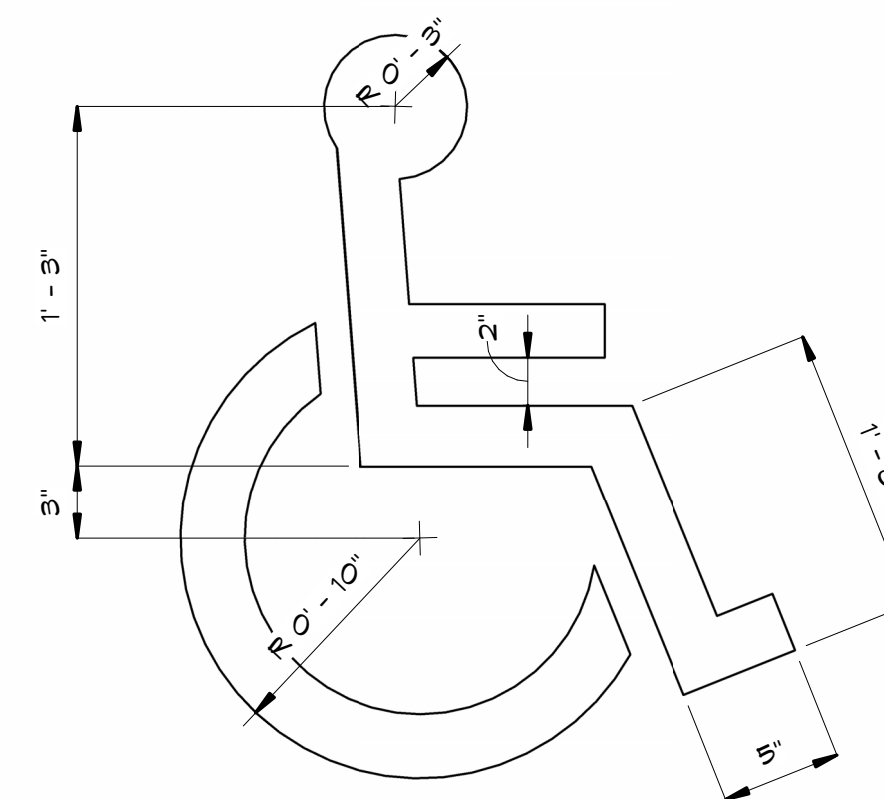

Technical drawing of a disabled parking sign assembly. The drawing shows a sign on a post with a concrete footing. Dimensions are indicated with arrows and text:

- Sign Dimensions:**
 - Width: 1' - 0"
 - Height: 1' - 6"
- Sign Content:**
 - Top: International Symbol of Access (wheelchair icon)
 - Text: PARKING BY DISABLED PERMIT ONLY
- Post and Footing:**
 - Post: 2" METAL POST
 - Grade: FINISH GRADE OF ADJACENT SIDEWALK
 - Footing: 18"x18"x18" CONCRETE FOOTING
 - Footing Dimensions: 1' - 6" (width) x 3' (depth) x 1' - 6" (height)

11 HANDICAP PARKING LOGO
1 1/2" = 1'-0"

12 HANDICAP PARKING SIGN
1" = 1'-0"

